

LOCATION:

Watertown, MA

CLIENT:

Town of Watertown

PROJECT TYPE:

Roadway Reconstruction

PROJECT SUMMARY:

- Traffic Calming
- Pedestrian Accommodations
- Roadway Alignment Improvements

Traffic Solutions was retained by the Town of Watertown to design roadway improvements, pedestrian enhancements and traffic calming features along Waverley Avenue from Main Street to Quirk Street. Driver speed was found to be excessive along this segment of Waverley Avenue which is adjacent to the Watertown Middle School. Segments of sidewalk had unusual grading not in conformance with ADA and AAB requirements. The roadway was unnecessarily wide resulting in long crosswalks. Sight distance was not adequate from the side streets. The combination of speed, inadequate sidewalks, long crosswalks and poor sight distance resulted in an environment that was not pedestrian friendly despite the heavy volume of school children that crossed the roadway each day.

A series of improvements were designed to resolve the roadway's deficiencies and provide a safe pedestrian-friendly environment. Traffic calming features were incorporated into the design including raised intersections, raised crosswalks, and streetscape enhancements. The roadway was narrowed and bump-outs were provided resulting in shorter crosswalks. Reconstructed sidewalks were designed to conform to the latest criteria of ADA and AAB. Intersections were realigned to provide adequate sight distance. Illuminated signs were also provided for increased visibility.

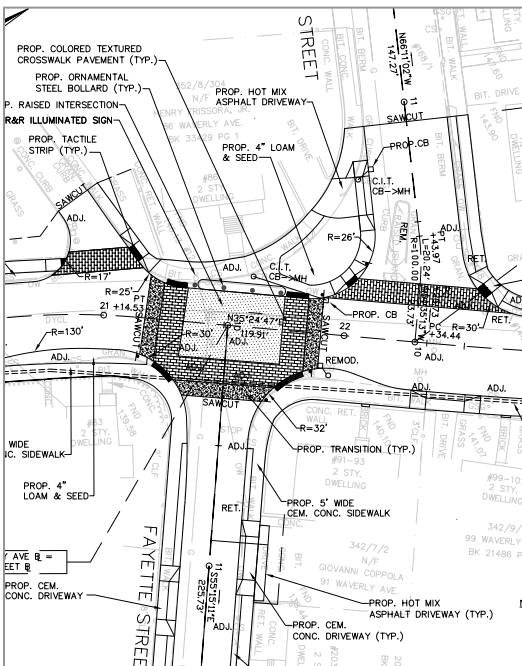

raised intersection example